

HANDLING AND CARE

To maintain the perfect look of your frames, you should clean them completely and regularly using a cleaning cloth.

Using harsh detergent for cleaning is strongly discouraged as this can attack and damage the coating, the silicon and plastic parts as well as the lens itself. It is also not recommended to clean your glasses under running water as liquid can collect in the grooves between lens and frame and may, over time, lead to undesirable deposits.

Regular cleaning of the frame prevents the formation of any corrosive substances that in some circumstances could affect the frame's surface and the appearance of the glasses lenses.

WARNING

TECHNICAL INFORMATION

ROUNDTEN

ETERNAL FLEXITAL® EYEWEAR

HOW TO REMOVE THE ACETATE RINGS FROM THE FRONT

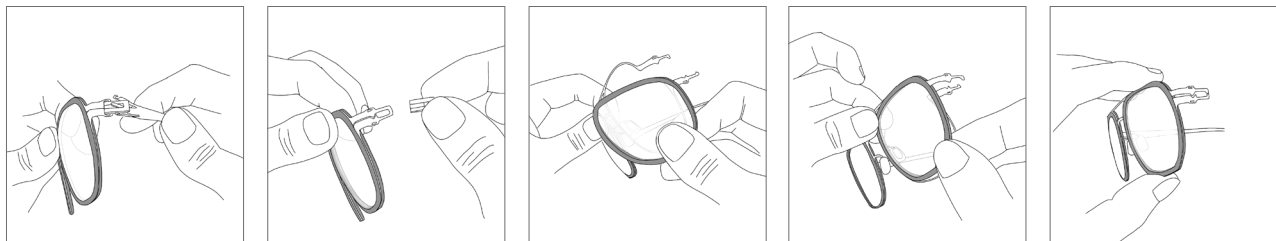

If you want to change the acetate RINGS, we strongly advise you to disassemble the temple, remove the metal lock, and then the rings.

HOW TO ADJUST THE PANTOSCOPIC ANGLE

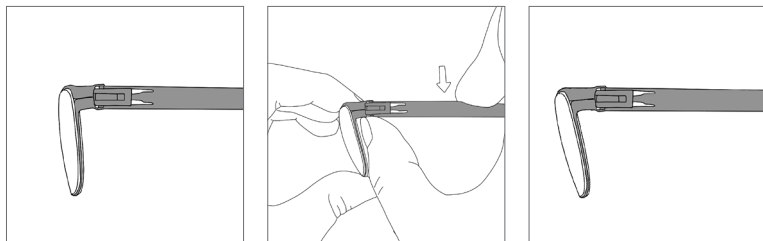

Thanks to the flexibility of our FLEXITAL metal, you can slightly adapt the pantoscopic angle of the front. We do not recommend performing this exercise on a regular basis.

TEMPLES – THE POSITION OF THE HINGE

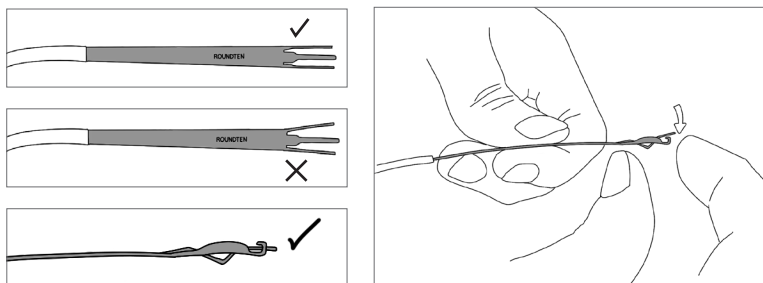

The 2 outer parts of the temple are to be securely clicked onto each side of the hinge lock, keeping the tongue in the middle on the same level. However, they must NOT be spread too wide either, as the temple will then be difficult to disassemble. If necessary, bend them back together to keep everything parallel.

If you notice a drop tension in the hinge, simply bend the middle part (the tongue) back into its original position, so that the temple is firmly locked, and not loose in any way.

ENDING PROCEDURE AND FITTING THE LENSES

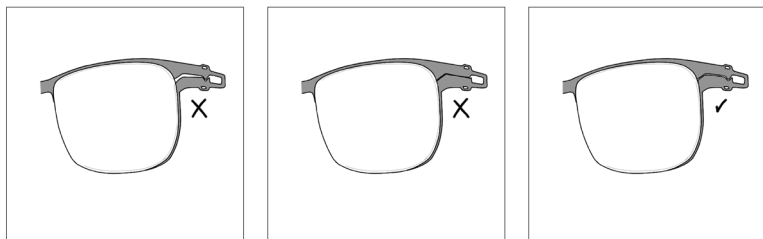

When fitting the lenses, we recommend high-index plastic ($n \geq 1.6$) 2.2mm thickness. The groove should be between 0.70mm and 0.75mm wide and 0.4mm or 0.5mm deep. A correct fit ensures the perfect tension in the hinge and gives the frame the necessary stability: when a lens is cut to the correct size, the space between the two sides of the hinge will be parallel. We also recommend using silicone rings to fix the round lenses.

HOW TO REMOVE THE LENSES - ACETATE FRAMES

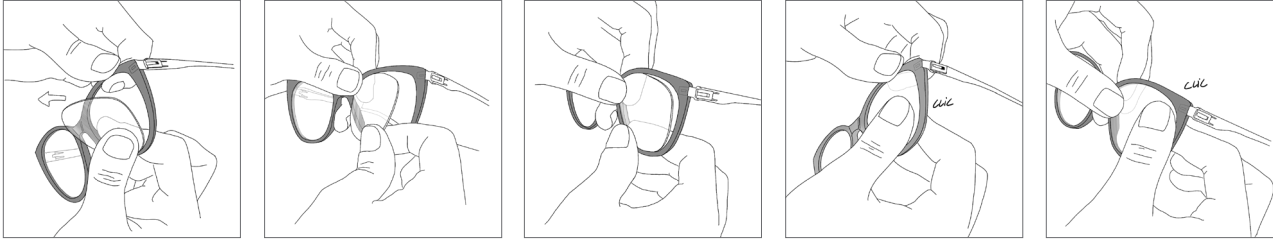

To remove the lenses of the acetate models it is not necessary to disassemble the temples nor the metal-lock – standard acetate fitting.

HOW TO REMOVE THE LENSES FROM THE ACETATE RINGS

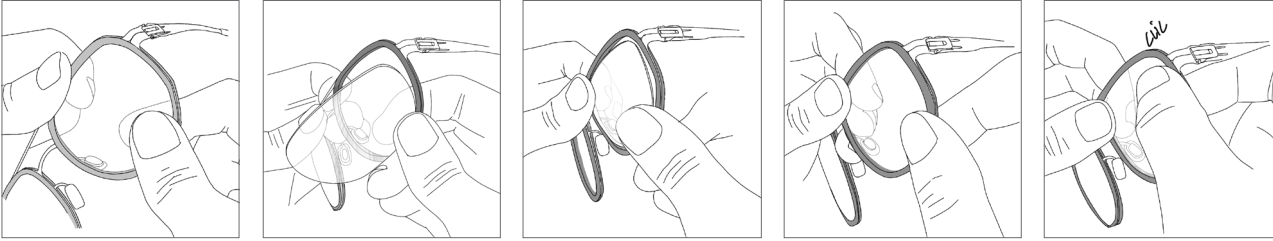

To remove the lenses of the models with acetate rings, it is not either necessary to disassemble the temples nor the metal-lock.

THE ROUNDTEN HINGE LOCK

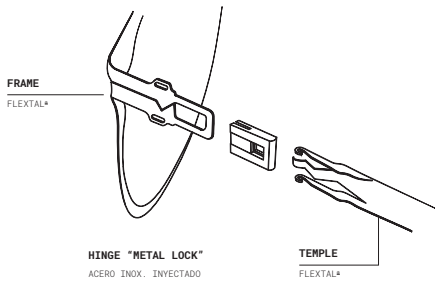

To ensure long-term satisfaction with your purchase, please take note of the following instructions for the care and use of your glasses.

The ROUNDTEN hinge combines a simple-to-manipulate system and a metal lock made of a much tougher stainless steel than the Flexital® material.

THE ROUNDTEN SYSTEM does not require any type of tool to fully disassemble and assemble any parts. The stiffer metal lock allows a high and seamless absorption of pressure, ensuring the integrity of the product.

Scan the QR code for more information

HOW TO REMOVE THE LENSES – METAL FRAMES

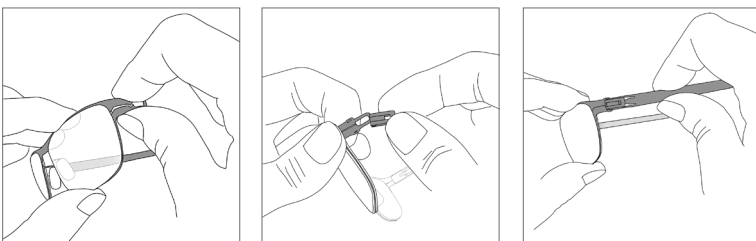
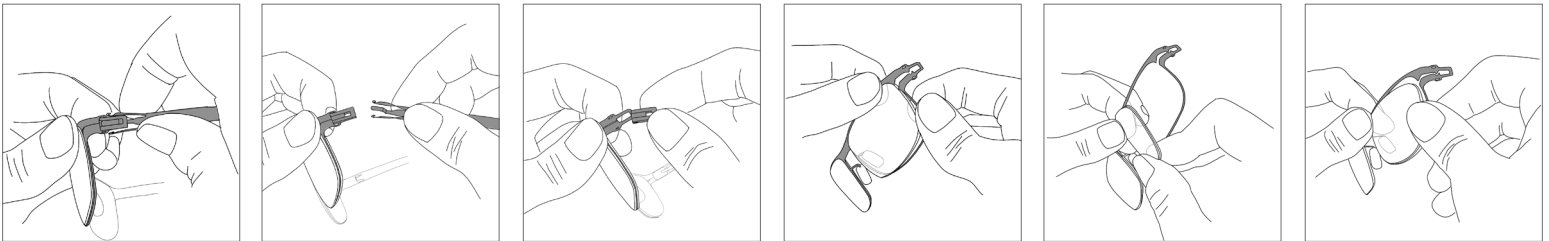

With the ROUNDTEN hinge you do not need any tools to remove and replace the lenses. Simply remove the temple as of our online instructions, or scan the bar code from each frame brochure explaining how to easily remove the temples, then the metal lock to finally separate the two sides of the front taking out the lenses. Do the opposite process to mount the lenses. See the information on the other side regarding the grooved lenses.